

Composite dry sliding bushings, metric dimensions

Principal dimensions			Basic load ratings		Mass	Designation
d	D	B	dynamic C	static C0		
mm			kN		kg	-
<b>30</b>	34	40	140	300	0,054	PCM 303440 M

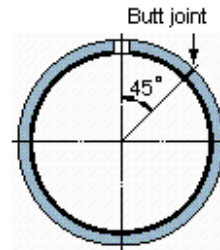
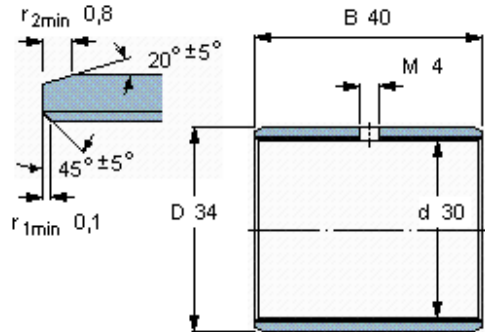

**Specific load factor** K 120  
**Material constant**  $K_M 1900$